

cobas® STI Testing Sample Collection with the cobas® PCR Media Kits

URINE SAMPLE COLLECTION

Prior to sampling, the patient should not have urinated for at least one hour. Given that collection of larger volumes of urine may reduce test sensitivity, please direct patient to provide first-catch urine (approximately 10 to 50 mL of the initial urine stream) into a urine collection cup (not provided).

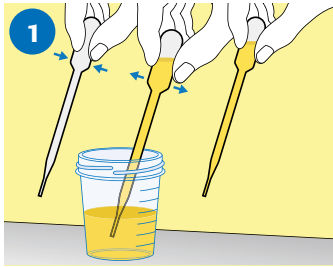

PIPETTE: Immediately transfer the urine into the **cobas®** PCR Media Tube using the provided disposable pipette.

NOTE: If the urine specimen cannot be transferred immediately, it can be stored at 2°C to 30°C for up to 24 hours.

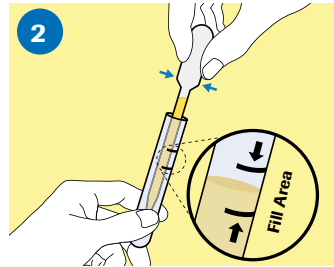

TRANSFER: The correct volume of urine has been added when the fluid level is between the two black lines on the tube label.

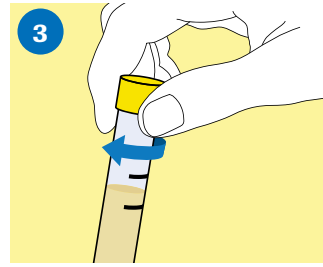

CAP: Tightly re-cap the **cobas®** PCR Media Tube.

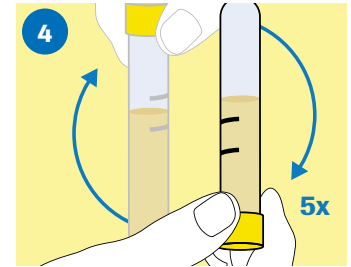

MIX: Invert the tube 5 times to mix. The specimen is now ready for transport.

VAGINAL SWAB SAMPLE COLLECTION

NOTE: Do not pre-wet the swab in **cobas®** PCR Media before collection.

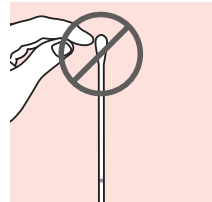
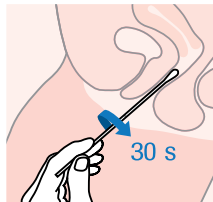
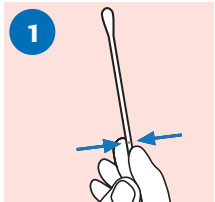

COLLECT: To collect the specimen, hold the woven swab with the scoreline above your hand and insert the swab about 5 cm (2 inches) into the vaginal opening. Gently turn the swab for about 30 seconds while rubbing the swab against the walls of the vagina. Withdraw the swab carefully. Do not let the swab touch any surface before placing it into the collection tube.

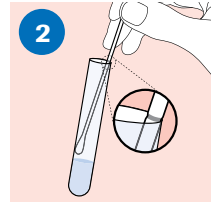

ALIGN: Remove the cap from the **cobas®** PCR Media Tube and lower the swab specimen into the tube until the visible scoreline on the swab shaft is aligned with the tube rim.

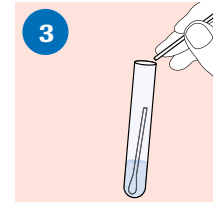

BREAK: Carefully leverage the swab against the tube rim to break the swab shaft at the scoreline.

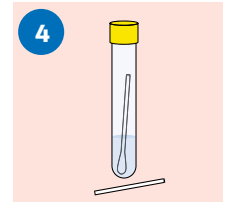

CLOSE: Tightly re-cap the **cobas®** PCR Media Tube. The specimen is now ready for transport. Discard the top portion of the swab.

ENDOCERVICAL SWAB SAMPLE COLLECTION

NOTE: Do not pre-wet the swab in **cobas®** PCR Media before collection.

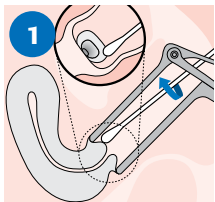

CLEAN: Using the woven swab, remove excess mucus from the cervical os and surrounding mucosa. Discard swab after cleaning.

NOTE: Cleaning excess mucus from the cervical os is required to ensure an adequate sample is obtained for processing.

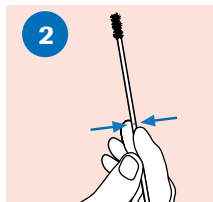

COLLECT: To collect the specimen, hold flocked swab with the scoreline above your hand and insert into the endocervical canal. Gently rotate the swab 5 times in one direction in the endocervical canal. Do not over-rotate. Carefully withdraw the swab, avoiding any contact with the vaginal mucosa.

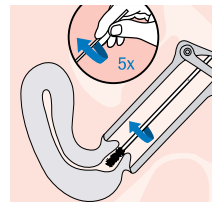

ALIGN: Remove the cap from the **cobas®** PCR Media Tube and lower the swab specimen into the tube until the visible scoreline on the swab shaft is aligned with the tube rim. The bud of the swab should not be submerged into liquid prior to breaking the shaft.

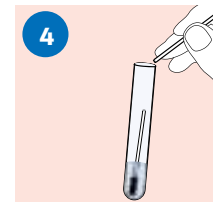

BREAK: Carefully leverage the swab against the tube rim to break the swab shaft at the scoreline.

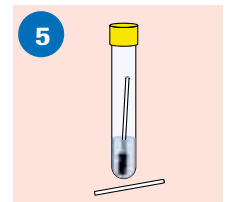

CLOSE: Tightly re-cap the **cobas®** PCR Media Tube. The specimen is now ready for transport. Discard the top portion of the swab.

Specimen	Collection and Transport Kit	Sample Stability	Testing Volume
Male & Female Urine	cobas [®] PCR Urine Sample Kit	12 months	850 µL
Endocervical	cobas [®] PCR Media Dual Swab Sample Kit	12 months	400 µL
Vaginal	cobas [®] PCR Media Uni Swab Sample Kit cobas [®] PCR Media Dual Swab Sample Kit	12 months	400 µL

URINE SAMPLE COLLECTION TIPS

- Prior to sampling, the patient should not have urinated for at least one hour.
- This sample is a first-catch sample, not a mid-stream collection such as is used for urine culture.
- Not a lot of urine is needed; collect 10 - 50 mL of urine.

URINE SPECIMEN TRANSPORT AND STORAGE

- Ensure that the cap is tightened when closing the **cobas**[®] PCR Media Tube.
- Urine specimens must be transferred into the **cobas**[®] PCR Media Tube (stabilized) immediately. If specimens cannot be transferred immediately, they can be stored at 2°C to 30°C for up to 24 hours.
- Transport and store the **cobas**[®] PCR Media Tube containing the stabilized urine specimen at 2°C to 30°C. Stabilized urine specimens are stable at 2°C to 30°C for up to 12 months.

ENDOCERVICAL AND VAGINAL SWAB SPECIMEN COLLECTION TIPS

- Vaginal lubricants, speculum jellies, creams, and gels containing carbomer(s) may interfere with the test and should not be used during or prior to sample collection.
- If the collected specimen contains excess blood (specimen has a red or brown color), it should be discarded and not used for testing.
- Avoid contact of the **cobas**[®] PCR Media with the skin, eyes or mucous membranes. If contact does occur, immediately wash with large amounts of water.
- For **endocervical sample collection** with the **cobas**[®] PCR Media Dual Swab Kit, use the woven swab for cleaning and the flocked swab for sample collection.
- For **vaginal sample collection** with the **cobas**[®] PCR Media Uni or Dual Swab Kits, use only the woven swab for sample collection. Discard the flocked swab.

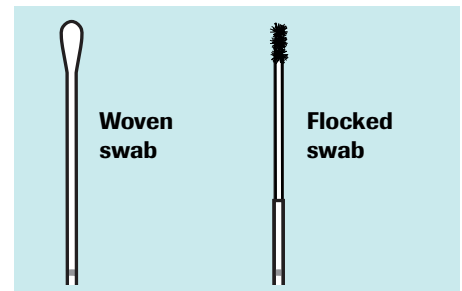

SWAB SPECIMEN TRANSPORT AND STORAGE

- Ensure that the cap is tightened when closing the **cobas**[®] PCR Media Tube.
- Transport and store the **cobas**[®] PCR Media Tube containing the collection swab at 2°C to 30°C.
- The specimen should only contain one swab and may be rejected if the tube contains no swab or two swabs.